

The 'DIR' range of recessed modular Direct / Indirect luminaires are designed for compatibility with most popular ceiling systems and providing added visual interest combined with well controlled luminance.

The canopy is constructed from zintec sheet steel finished white RAL9010 20% gloss polyester powder paint.

Fused high frequency control gear is offered as standard with analogue or digital dimmable control gear optional; all being accessible from within the canopy.

Four louvre options are available as standard including a Miro low iridescent specular (Cat.2 200) and semi specular (Cat.2 500) wedge cross blade louvre retained by positive locating leaf spring clips. The louvre is flanked each side by a gently curved diffused micro perforated baffle allowing a soft toned and added visual appearance.



SPECIFICATION

Body

- Body compatible with 15mm, 24mm exposed T and sprung T ceiling systems
- Enclosed solidly constructed body
- Integral fused high frequency control gear
- Alternative gear options available
- Luminaire shown DIR66 255 WB2
- Air handling available
- Light trap around louvre aperture eliminates light spill
- End diaphragms to hide lamp end caps
- Positive retention by spring clips

Louvre

- **WB2** : 200 cd. specular Miro wedge louvre
- **WB5** : 500 cd. semi specular wedge louvre
- **WSW** : Semi specular wedge with white reflector louvre
- **WBL** : White blade with semi specular reflector louvre

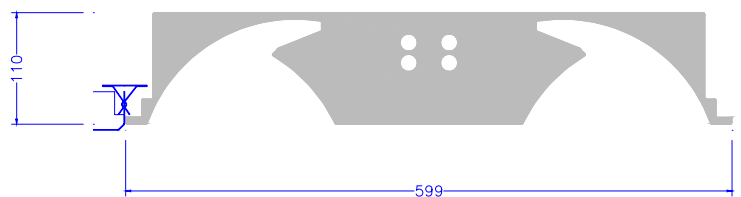
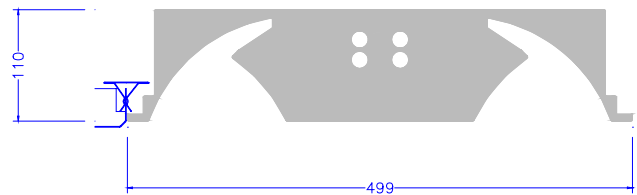

Cat. No.	Dimensions	Lampways	Approx. Wt
DIR55 136/WB2	499 x 499 x 110	1 x 36w TC-L	5.2 kg
DIR55 236/WB2	499 x 499 x 110	2 x 36w TC-L	5.2 kg
DIR66 140/WB2	599 x 599 x 110	1 x 40w TC-L	6.5 kg
DIR66 240/WB2	599 x 599 x 110	2 x 40w TC-L	6.5 kg
DIR66 155/WB2	599 x 599 x 110	1 x 55w TC-L	6.5 kg
DIR66 255/WB2	599 x 599 x 110	2 x 55w TC-L	6.5 kg

Change WB2 suffix to alternative if required e.g. DIR66 240/WB2 becomes DIR66 240/WBL

EMERGENCY Add suffix to above catalogue references

/M3 Integrally mounted self contained 3 hour emergency

/ST Integral 'Self Test' for emergency luminaires only
i.e. DIR66 255 WB2/M3/ST