

The 'SM' range of surface linear and modular luminaires are designed to utilise the advantages of T5 lamp technology making it ideally suited for the modern interior.

The canopy is constructed from zinc coated sheet steel with perforated sides and finished RAL9010 20% gloss, creating a sleek and pleasing profile. Alternative paint finishes available on request.

Fused high frequency control gear is offered as standard with analogue or digital dimmable control gear optional. High output T5 lamp control gear is also available.

Four louvre attachments are available as standard including a low iridescent specular (Cat.2 200) and semi specular (Cat.2 500) Miro wedge louvre to match lamp configuration and retained by positive locating leaf springs. For lower specification areas a one piece polycarbonate Tp (a) dish controller is available.



SPECIFICATION

Body

- Rigidly constructed body with welded ends
- Integral fused high frequency control gear
- Alternative gear options available
- Luminaire shown SM122 228/WBL
- 'Spiderpak' wire suspension kit for 1.0m and 2.0m drop Add suffix 'SP1' and 'SP2' respectively

Options

- **WB2** : 200 cd. specular Miro wedge louvre
- **WB5** : 500 cd. semi specular wedge louvre
- **WSW** : Semi specular wedge with white reflector louvre
- **WBL** : White blade with semi specular reflector louvre
- **PDP** : Polycarbonate Tp (a) prismatic dish diffuser

Suspension kits :-

- /SP1** 1.0m wire suspension 'Spiderpak' kit
- /SP2** 2.0m wire suspension 'Spiderpak' kit

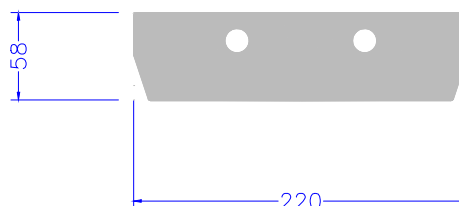
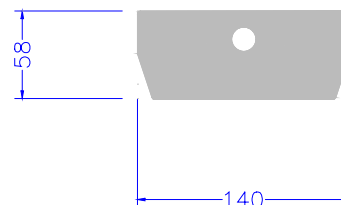

Cat. No.	Dimensions	Lampways	Approx. Wt.
SM121 128/WB2	140 x 1195 x 58	1 x 1200mm 28w T5	6.4 kg
SM122 228/WB2	220 x 1195 x 58	2 x 1200mm 28w T5	6.5 kg
SM151 135/WB2	140 x 1495 x 58	1 x 1500mm 35w T5	8.2 kg
SM152 235/WB2	220 x 1495 x 58	2 x 1500mm 35w T5	8.3 kg
SM66 314/WB2	600 x 595 x 58	3 x 600mm 14w T5	5.3 kg
SM66 414/WB2	600 x 595 x 58	4 x 600mm 14w T5	5.4 kg
SM66 3x114/WB2	600 x 595 x 58	3x1 600mm 14w T5	5.3 kg
SM66 2x214/WB2	600 x 595 x 58	2x2 600mm 14w T5	5.5 kg

Change WB2 suffix to alternative if required e.g. SM121 128/WB2 becomes SM121 128/PDP

EMERGENCY Add suffix to above catalogue references

/M3 Integrally mounted self contained 3 hour emergency

/ST Integral 'Self Test' for emergency luminaires only i.e. SM66 314/WB2/M3/ST